

Countryside Condos

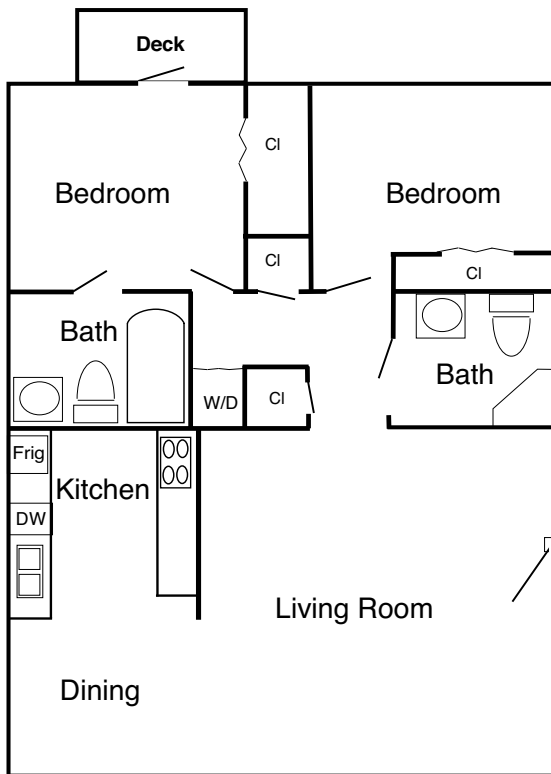

Address | Woodpecker Lane

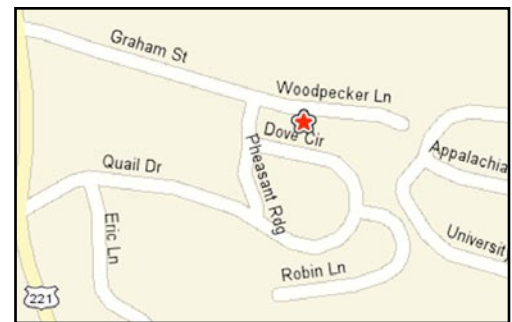

Go to www.yahoomaps.com.

Price per month

| | | | |
|-------------|--------|--------|--------|
| Individuals | 1 | 2 | 3 |
| Price | \$ 830 | \$ 830 | \$ 900 |

Notes:

| | | | | | | |
|--------------|--------------|--------------|------------|-----------|-----------|----------|
| Walking: N | AppalCart: Y | Driving: Y | | 1st level | 2nd level | Flooring |
| Age: 1984 | Garage: N | Range: elec. | Foyer | | | |
| Ext: wood | Closets: 4 | Refrig: Y | Living Rm. | X | | carpet |
| Roof: asp. | Porch: Y | Dish W: Y | Dining Rm. | X | | carpet |
| Water: city | Patio: N | Disp: N | Kitchen | X | | vinyl |
| Sewer: city | Base: N | W: Y | Bedrooms | 2 | | carpet |
| Heat: EBB | Drive: paved | D: Y | Baths | 2 | | vinyl |
| Hot W: elec. | Road: paved | Frpl: N | | | | |

No utilities included.

Units have a built-in microwave. In each unit, one bath has a corner shower.

